

INSTRUCTION SHEET

CARTER MODEL BB, BBR1 CARBURETOR

Numbers used in disassembly and reassembly procedures are the reference numbers on the illustration on the reverse side. Complete disassembly and reassembly instructions are included. If certain subassemblies do not require disassembling, follow only applicable instructions.

I. DISASSEMBLY.

Remove carburetor from engine and drain out gasoline. Loosen screw (3) and remove throttle lever (1). Lift off throttle shaft dog (5) and unhook choke connector rod (6) from choke lever. Separate the throttle shaft dog (5) from rod (6). Remove the four screw and lock washer assemblies (7) and lift off air horn assembly (10), carefully. Remove gasket (11).

Lift out float pin retainer (12), float (13), and float pin (14). Remove pin spring (15), unhook link (16), and lift out the pump plunger assembly. Press pump plunger (17) through connector link (18) until the notch engages the slot, and rotate plunger one-fourth turn to disengage the parts. Lift off spring retainer (19) and pump spring (20). Remove idle tube (26), lift out step-up piston assembly (21), and spring (22). Remove gasket (23) from step-up piston cylinder. Remove step-up jet (24), plug (27), pump jet (28), plug (29) and ball (30). Using a small screwdriver or special tool, pry out retainer ring (31) and remove ball (32). Remove the main jet (33). Remove plug (35). (Tap plug under head lightly with small, dull chisel to loosen it.) Remove needle and seal (37) and gasket (38). Do not remove main vent tube (36) unless special tool is available.

Disengage the body from the throttle flange by taking out screw and lock washer assemblies (39). Lift off gaskets (42), and insulator (43). Remove idle adjusting screw (44), spring (45), both screws (46), throttle valve (47), and throttle shaft (48). Remove screw (54), lock washer (55), and choke tube bracket (52). Unhook spring (50). Remove choke valve screws (49), choke valve (49), and choke shaft (51).

II. CLEANING.

Cleaning must be done with carburetor taken apart. Soak carburetor parts long enough to soften and remove all foreign material. Use 1) a regular carburetor cleaning solvent; 2) lacquer thinner; or 3) denatured alcohol. Use a small brush to aid in cleaning parts, if necessary. Make certain carburetor bore is free of all hard carbon deposits. Do not boil carburetor in alkaline solution as it destroys the protective coating on castings.

Blow out all passages in casting with dry, compressed air, and check passages and orifices carefully. (See illustration.)

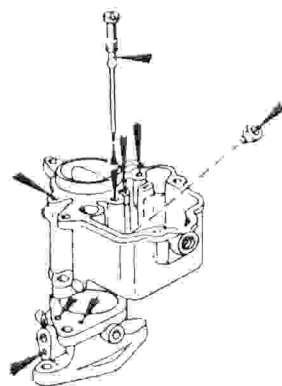

III. REASSEMBLY.

Insert throttle shaft (48) and throttle valve (47). Position throttle valve so that trademark faces idle port and intake manifold. Hold valve closed and insert screws (46). Tap valve with a screwdriver blade to settle it in bore and tighten screws (46). Install idle adjusting screw (44), and spring (45). Run screw down until it just seats — do not force — then back screw out approximately one turn.

Make certain vent tube (36) is not damaged, and install a new plug (35). If other passage plugs have been removed for cleaning purposes, replace them. Install needle and seat (37),

gasket (38), main jet (33), gasket (34), pump jet (28), plug (27), step-up jet (24), gasket (25), ball (30), and plug (29). Place gasket (23) and spring (22) in step-up cylinder and insert step-up piston assembly (21) in conjunction with idle tube (26). Guide step-up needle into jet (24). Place ball (32) in its seat in pump cylinder, and replace retainer ring (31) with gap opposite ball (32).

Attach body to flange using gaskets (42), insulator (43), and screws (40). Make certain all passages are open. Place spring retainer (19) and pump spring (20) on plunger (17), and assemble plunger (17) to link (18). Insert plunger assembly in body. Hook link (16) into link (18) and connect to middle hole of throttle lever (48). Replace pin spring (15).

Close throttle and measure height of plunger (17) above top edge of body casting. (See illustration.) Open throttle wide and again measure height of plunger above body casting. The difference between these two measurements should be 3/8 inch. Bend link (18) (see illustration) to effect this adjustment. Place float pin (14) in

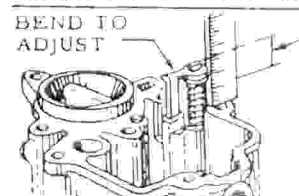

float lever and insert float (13) in body. Hold float lip against the inlet needle with slight pressure downward, and measure float height. (See illustration.) Measure with the 5/64-inch pads on the float gage. Bend lip on float lever to effect an adjustment. Install float pin retainer (12).

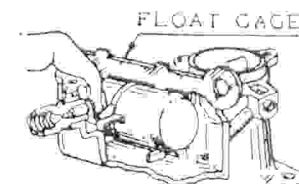

Install choke tube bracket (52) with screw (54) and lock washer (55). Insert choke shaft (51) in air horn (10), and hook up spring (50). Install choke valve (49) with relief toward inside of carburetor. Insert screws (46) and tap choke to settle it in air horn. Tighten screws and open and close choke to check for freedom of movement. Install air horn assembly with gasket (11) and four screw and lock washer assemblies (7). Hook choke connector rod (6) into choke lever and hook throttle shaft dog (5) on lower end of rod (6). Place dog (5) on its shaft stud and slide on the throttle lever assembly (1). Hold lever (1) tight against throttle shaft flat and tighten screw (3). Install throttle stop screw (4), if removed.

NOTE

Be sure to use a slotted flange gasket (61) when installing carburetor on intake manifold.

IV. IDLE ADJUSTMENT. (See illustration.)

Adjust throttle stop screw (1) to crack throttle valve slightly. Start engine. Adjust mixture screw (2) until engine idles smoothly. Re-adjust stop screw (1) to idle engine at approximately 450 rpm, then readjust mixture screw (2) if necessary.

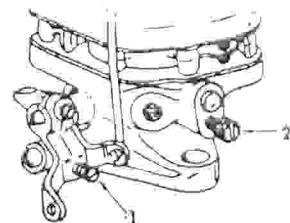

PARTS LIST

CARTER MODEL 88, 88R1 CARBURETOR

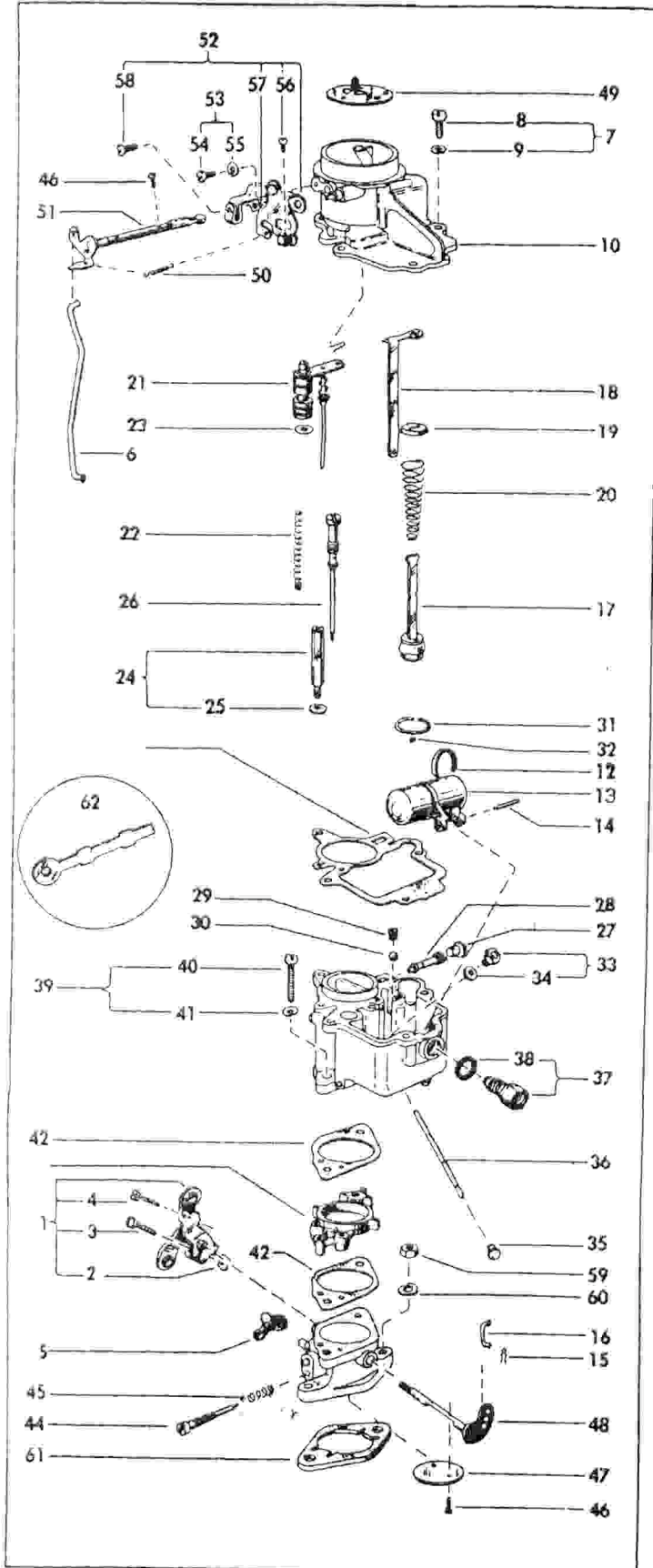

REF. NO.	NOMENCLATURE
1	Lever Assembly - Throttle
2	Nut - Throttle Lever Clamp
3	Screw - Throttle Lever Clamp
4	Screw - Throttle Adjusting
5	Dog - Throttle Shaft
6	Rod - Choke Connector
7	Screw and Washer Assembly - Air Horn
8	Screw - Air Horn Attaching
9	Washer - Lock (15/64 in. I.D.)
10	Air Horn Assembly
11	Gasket - Body
12	Retainer - Float Lever Pin
13	Float and Lever Assembly
14	Pin - Float Lever
15	Spring - Pin
16	Link - Pump Operating
17	Plunger and Rod Assembly
18	Link - Pump Connector
19	Retainer - Pump Spring
20	Spring - Pump
21	Piston Assembly - Step-up
22	Spring - Step-up Piston
23	Gasket - Step-up Piston
24	Jet and Gasket Assembly - Step-up
25	Gasket - Step-up Jet
26	Tube - Idle Orifice
27	Plug - Pump Jet Rivet
28	Jet - Pump
29	Plug - Pump Check
30	Ball - Pump Check
31	Ring - Pump Check Retainer
32	Ball - Pump Cylinder
33	Jet Assembly - Main Metering
34	Gasket - Main Metering Jet
35	Plug - Main Vent Tube Rivet
36	Tube - Main Vent
37	Needle and Seal Assembly
38	Gasket - Needle Seat
39	Screw and Washer Assembly
40	Screw - Flange Attaching
41	Washer - Lock (9/32 in. I.D.)
42	Gasket - Body Flange
43	Insulator
44	Screw - Idle Adjusting
45	Spring - Idle Adjusting Screw
46	Screw - Valve Attaching
47	Valve - Throttle
48	Shaft and Arm Assembly - Throttle
49	Valve Assembly - Choke
50	Spring - Choke Pull Back
51	Lever and Shaft Assembly - Choke
52	Bracket Assembly - Choke Tube
53	Screw and Washer Assembly - Choke Bracket
54	Screw - Choke Bracket Attaching
55	Washer - Lock (11/64 in. I.D.)
56	Screw - Wire Clamp
57	Nut - Choke Tube Clamp
58	Screw - Choke Tube Clamp
59	Nut - Flange Stud
60	Washer - Flange Stud Lock
61	Gasket - Flange
62	Gage - Float Level