

INSTRUCTION SHEET

WEBER CARBURETOR — MODEL DHS A

IS-50-424-1

GENERAL EXPLODED VIEW

THE GENERAL DESIGN AND PARTS SHOWN WILL VARY TO INDIVIDUAL UNITS COVERED ON THIS INSTRUCTION SHEET.

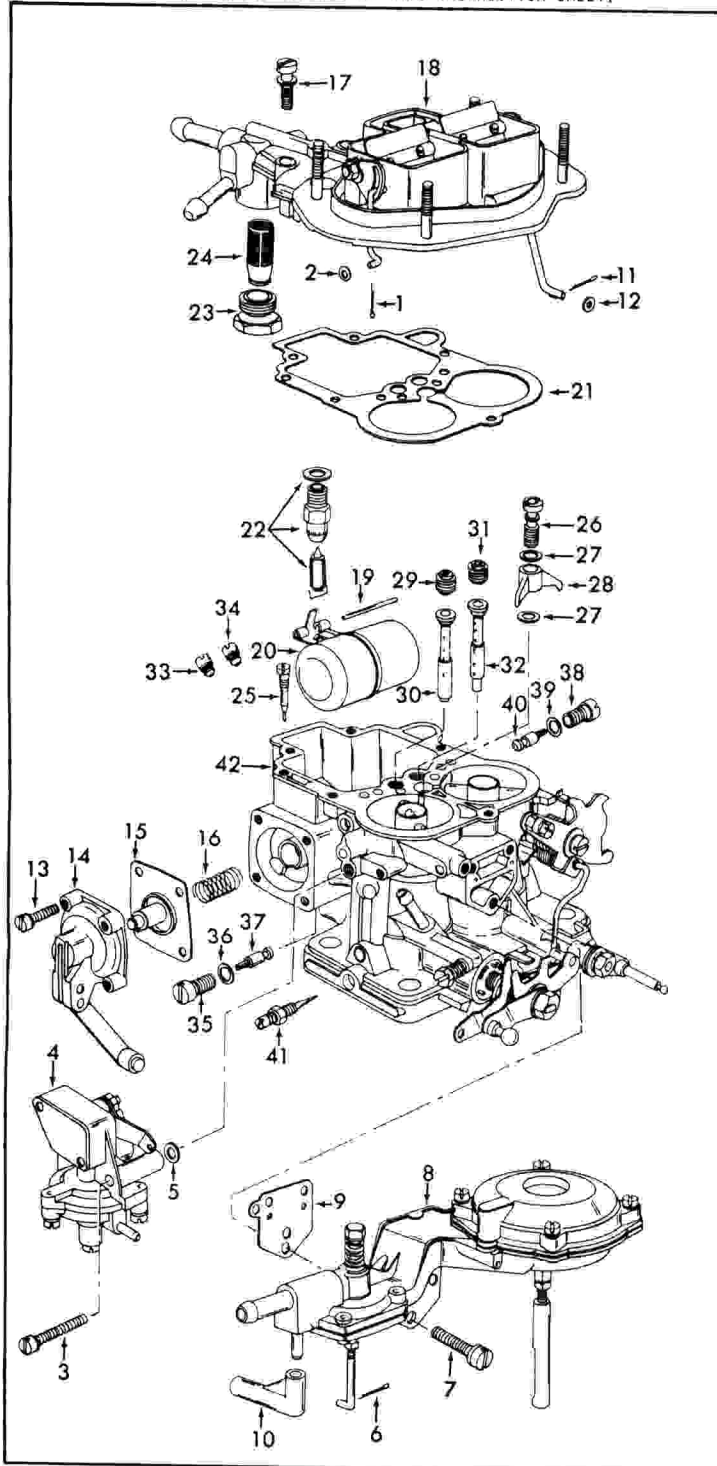

DISASSEMBLY

USE EXPLODED VIEW AS A GUIDE. THE NUMERICAL SEQUENCE MAY GENERALLY BE FOLLOWED TO DISASSEMBLE UNIT FAR ENOUGH TO PERMIT CLEANING AND INSPECTION. BE CAREFUL TO NOTE SIZES OF JETS AND MAIN WELL TUBES AND THEIR LOCATION FOR PROPER ASSEMBLY. (RECORD SIZES ON INSTRUCTION SHEET.) CAUTION: SCREWS AND NUTS USED IN THIS CARBURETOR HAVE METRIC THREADS. DO NOT SUBSTITUTE U.S. THREADED SCREWS OR NUTS.

NOMENCLATURE

REF. NO.	REF. NO.
1. COTTER PIN - CHOKE VALVE ROD	21. GASKET - FLOAT BOWL
2. WASHER - CHOKE VALVE ROD	22. NEEDLE, SEAT & GASKET ASSY.
3. SCREW & LOCKWASHER - CHOKE VALVE	23. PLUG - FILTER SCREEN
4. CHOKE PULL OFF VALVE	24. SCREEN - FUEL FILTER
5. SEAL - CHOKE PULL OFF VALVE	25. PLUG - PUMP CHANNEL
6. COTTER PIN - FAST IDLE VALVE ROD	26. VALVE ASSY. - PUMP DISC.
7. SCREW & LOCKWASHER - FAST IDLE & SECONDARY VALVE ASSY.	27. GASKET (2) - PUMP NOZZLE
8. VALVE ASSY. - FAST IDLE & SECONDARY THROTTLE	28. NOZZLE - PUMP DISCHARGE
9. GASKET - VALVE ASSY.	29. JET - PRIMARY AIR CORRECTION
10. TUBE - VALVE CONNECTOR	30. TUBE - PRIMARY EMULSION
11. COTTER PIN - CHOKE ROD	31. JET - SECONDARY AIR CORRECTION
12. WASHER - CHOKE ROD	32. TUBE - SECONDARY EMULSION
13. SCREW & LOCKWASHER - PUMP COVER	33. JET - PRIMARY MAIN
14. PUMP COVER ASSY.	34. JET - SECONDARY MAIN
15. DIAPHRAGM ASSY. - PUMP	35. JET HOLDER - PRIMARY IDLE
16. SPRING - PUMP DIAPHRAGM RETURN	36. SEAL - PRIMARY JET HOLDER
17. SCREW & LOCKWASHER - BOWL COVER	37. JET IDLE - PRIMARY
18. BOWL COVER ASSEMBLY	38. JET HOLDER - SECONDARY IDLE
19. PIN - FLOAT HINGE	39. SEAL - SECONDARY JET HOLDER
20. FLOAT ASSEMBLY	40. IDLE JET - SECONDARY
	41. NEEDLE & LOCKNUT - IDLE ADJUSTING
	42. MAIN BODY ASSEMBLY

CLEANING

CLEANING MUST BE DONE WITH CARBURETOR DISASSEMBLED. SOAK PARTS LONG ENOUGH TO SOFTEN AND REMOVE ALL FOREIGN MATERIAL. USE A CARBURETOR CLEANING SOLVENT. MAKE CERTAIN THE THROTTLE BORES ARE FREE OF ALL CARBON AND VARNISH DEPOSITS. RINSE OFF IN SUITABLE SOLVENT. BLOW OUT ALL PASSAGES IN CASTINGS WITH COMPRESSED AIR AND CHECK CAREFULLY TO INSURE THOROUGH CLEANING OF OBSCURE AREAS. CAUTION: DO NOT SOAK ASSEMBLYS WITH ATTACHED PLASTIC PARTS FOR A LONG PERIOD OF TIME. DO NOT SOAK ANY PARTS CONTAINING RUBBER OR DIAPHRAGM ASSEMBLYS IN CLEANING SOLVENTS.

REASSEMBLY

REASSEMBLE IN REVERSE ORDER OF DISASSEMBLY. NOTE: SPECIAL INSTRUCTIONS AND ADJUSTMENTS.

SPECIAL INSTRUCTIONS

IDLE ADJUSTING NEEDLE (41) - TURN IN UNTIL SEATED, THEN BACK OUT 1 1/2 TURNS.

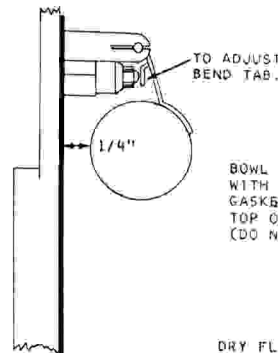

DRY FLOAT LEVEL ADJUSTMENT

BOWL COVER HELD IN A HORIZONTAL POSITION WITH FLOAT HANGING FREELY. MEASURE DISTANCE FROM BOTTOM OF FLOAT TO COVER GASKET.

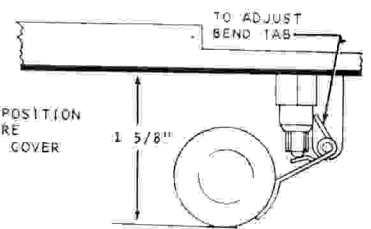

FLOAT DROP ADJUSTMENT